

KAI TAK HARBOUR

# MONACO

## MARINE

Unit A, 28/F, Tower 1A (Unmodified Show Flat)  
第1A座28樓A室 (無改動示範單位)

Location of Notice(s) 告示位置

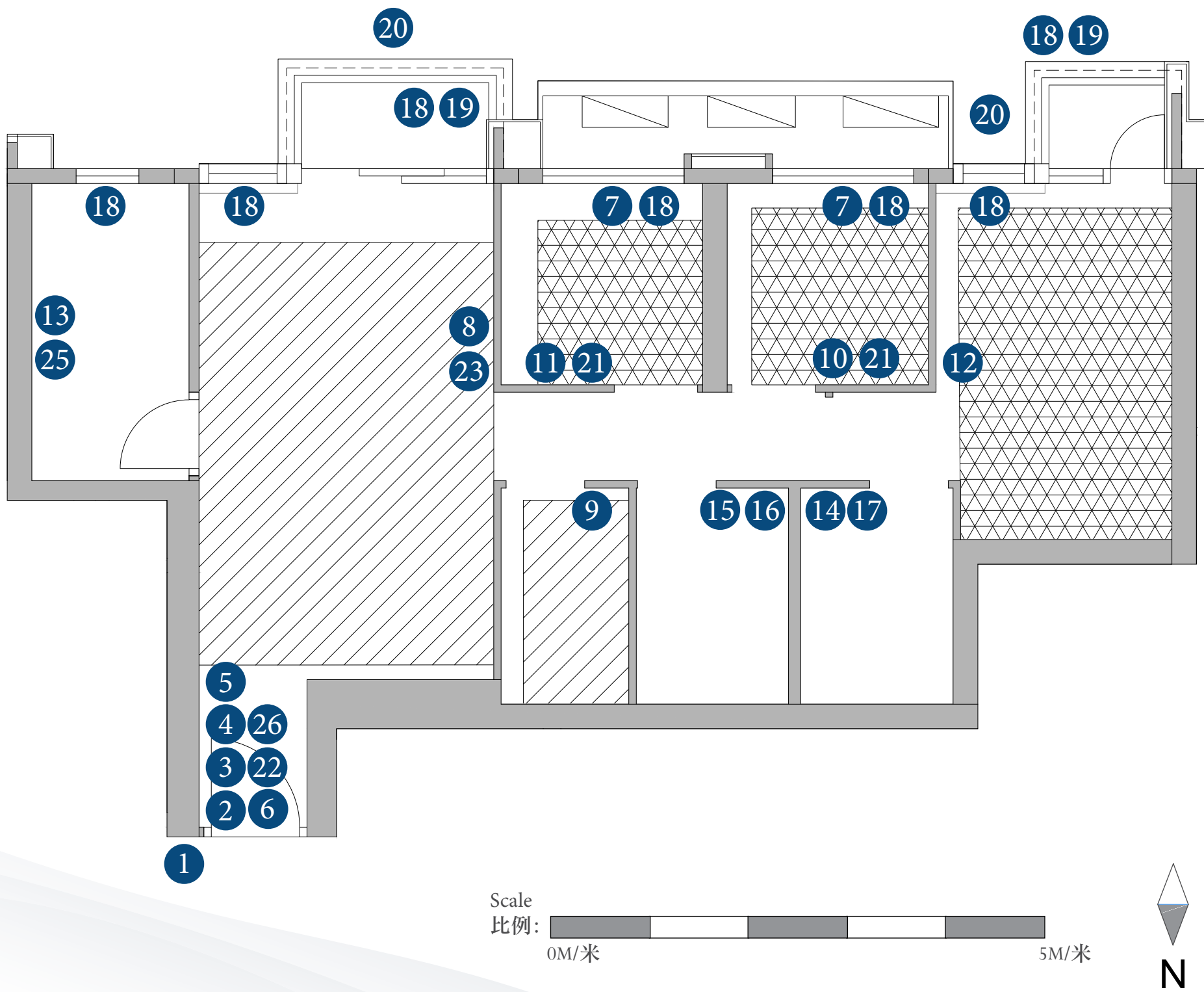

## Notice(s) 告示 1

This is not a mockup of the actual condition of the area outside the entrance door of the actual unit. Provisions, materials and finishes outside the main entrance door frame of this unmodified show flat are those of this sales office, and do not represent the actual provisions of the unit upon handover to the purchaser, and is/are not a mock-up of the external wall of the Phase or any architectural feature or finishes thereon. Please note that the design, location and orientation of the actual door frame, flat signage and door bell, etc. of the unit may be different from those shown here. For information on standard fittings, finishes and appliances of the residential property, please refer to the sales brochure.

此處並非模擬實際單位大門外範圍之實際狀況。此無改動示範單位入口大門門框外之裝置、物料及裝修物料屬於本售樓處的裝置、物料及裝修物料，並不代表單位交付給買方時之實際裝置，並非期數外牆或期數外牆上之建築裝飾或裝修物料的模擬。單位實際門框、單位門牌及門鈴等之設計、位置和方向與此處展示者或有不同，敬希注意。有關住宅物業之交樓標準裝置、裝修物料及設備的資料，請參閱售樓說明書。

DP-KTC2-SF-1

## Notice(s) 告示 2

This unmodified show flat is for showing the residential property concerned only and does not constitute and shall not be construed as constituting any representation or warranty whether express or implied in respect of the view from any residential property in the Phase or the external appearance of any part of the Phase, whether or not the external finishes, external pipes, or appearance of any part of the Phase have been shown. All views projected in this unmodified show flat are not views from the actual residential property, and shall not constitute or be construed as constituting any offer, undertaking, representation or warranty whether expressed or implied. Prospective purchasers should make reference to the sales brochure for details of the Phase. The vendor also advises prospective purchasers to conduct an on-site visit for a better understanding of the development site, its surrounding environment and the public facilities nearby.

本無改動示範單位僅作展示相關住宅物業之用，並不構成亦不得詮釋為任何不論明示或隱含關於期數任何住宅物業景觀或期數任何部份之外觀之陳述或保證，不論有否展示期數任何部份之外牆裝修物料、外在喉管或外觀。此無改動示範單位所示之景觀並非實際住宅物業的實景，並不構成亦不應被詮釋為任何明示或暗示之要約、承諾、陳述或保證。準買方如欲了解期數的詳情，請參閱售樓說明書。賣方亦建議準買方到發展項目地盤作實地考察，以對發展項目地盤、其周邊地區環境及附近公共設施有較佳了解。

DP-KTC2-SF-2

The dimensions of this unmodified show flat and of (if any) the bay window, utility platform and balcony in the unmodified show flat are slightly different from those as specified in relation to the residential property in the sales brochure due to the finishes on the enclosing walls or boundary walls or internal partitions of this unmodified show flat.

由於此無改動示範單位的圍封牆或邊界牆或內部間格的裝修物料所致，此無改動示範單位及(如有)其窗台、工作平台及露台的尺寸與售樓說明書就有關住宅物業所指明的尺寸略有分別。

DP-KTC2-SF-3

The fittings, finishes and appliances, such as air grilles, sprinklers, visual advisory alarms, emergency lighting, exit signs, speakers, exterior finishing materials and other features marked with green dots “●” in this unmodified show flat are the in-situ built-in finishes, equipment and facilities of this sales office, and are not part of the standard provisions of the residential property. There are no such finishes, equipment and facilities in the residential properties of the Phase and it may not be possible to install such finishes, equipment and facilities in the actual residential properties. For information on fittings, finishes and appliances of the residential properties in the Phase, please refer to the sales brochure. Except those mentioned above, and unless otherwise specified, all interior partitions, fittings, finishes and appliances in this unmodified show flat are the same as those depicted in the sales brochure.

本無改動示範單位內有綠色圓點“●”標示之裝置、裝修物料及設備，如通風格柵、消防花灑頭、視像警報器、應急照明燈、出路指示牌、擴音器、外牆裝修物料及其他裝置是為本售樓處現場固有的裝修物料、配套設備及設施，並非住宅物業之交樓標準。該期數之住宅物業並沒有此等裝修物料、設備及設施，亦未必可能裝設此等裝修物料、設備及設施。有關該期數之住宅物業的裝置、裝修物料及設備的資料，請參閱售樓說明書。除以上所述及另行特別註明者外，此無改動示範單位之內部間隔、裝置、裝修物料及設備一如售樓說明書所示。

DP-KTC2-SF-4

Exposed pipes, ducts and wiring will be hidden by the bulkheads/false ceiling in the actual residential property. Those exposed pipes, ducts and wiring have not been provided in this unmodified show flat.

實際住宅物業內之外露喉管、管道及電線將被假陣/假天花隱藏。該等外露喉管、管道及電線在此無改動示範單位內並無提供。

DP-KTC2-SF-5



Due to physical constraints of the venue, the floor-to-ceiling height of different parts of this unmodified show flat is less than the corresponding projected height of the parts concerned of the residential property as specified in the sales brochure (see the plan below for the height difference). Due to the finishes on the floor and ceiling of this unmodified show flat, it is possible that there will be a difference between the floor-to-ceiling height of the unmodified show flat obtained by taking measurements inside the unmodified show flat (it will not be able to take into account of the thickness of the aforesaid finishes when taking such measurements) and the projected height (less the aforesaid height difference) of the corresponding parts of the residential property.

“Projected height” in relation to a residential property, means the height of the residential property as calculated by deducting the thickness of the floor slab of the residential property as specified in relation to the residential property in the sales brochure of the Phase from the floor-to-floor height of the residential property as so specified.

因現場環境所限，此無改動示範單位不同部分的樓底高度(地面量度至天花板計)，低於售樓說明書內有關住宅物業相關部分的相應預計高度(高度差距見下圖)。因此無改動示範單位地板及天花板均有裝修物料，於無改動示範單位內量度出之樓底高度(地面量度至天花板計)(如此量度得出之樓底高度未能將上述裝修物料厚度納入計算之中)可能會與有關住宅物業相關部分減去上述高度差距後的相應預計高度不同。

「預計高度」就某住宅物業而言，指按照以下算式計算得出的該物業的高度：將期數的售樓說明書中就該物業指明的層與層之間的高度，減去如此指明的該物業的樓板的厚度。

Please see the plan below for the above mentioned height difference.  
有關上述高度差距，請參閱下圖。

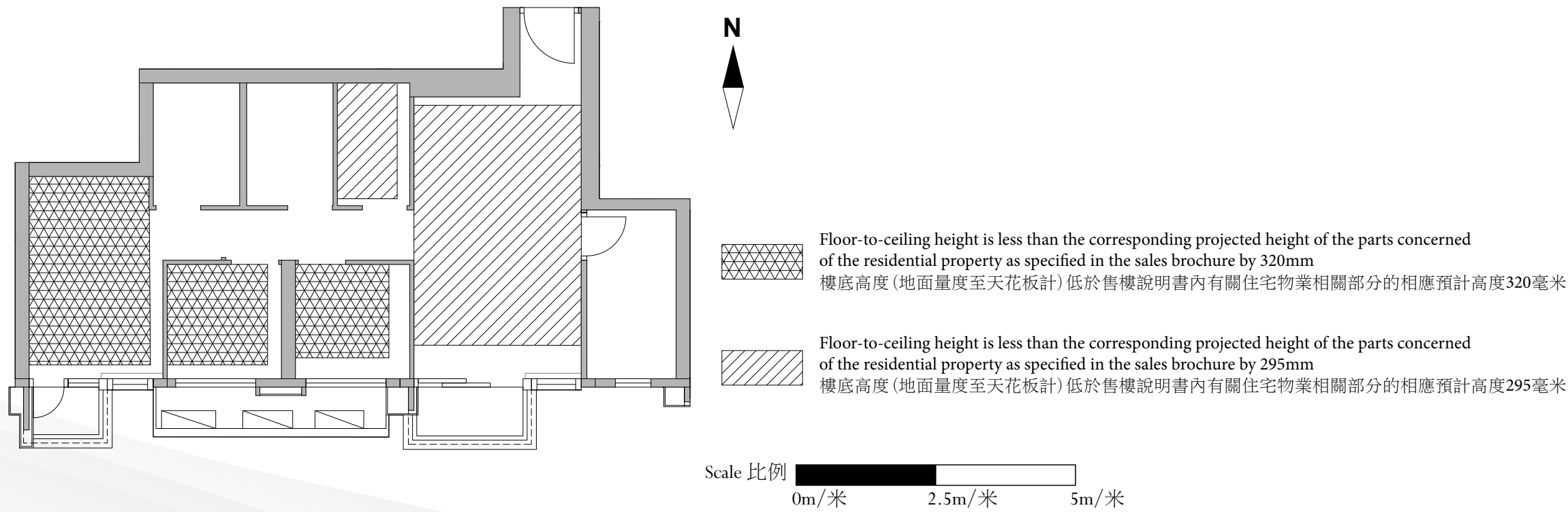

DP-KTC2-SF-6



## Notice(s) 告示 7

The split type air-conditioning outdoor unit(s) of Flat A on 28/F of Tower 1A is installed on the air-conditioning outdoor unit platform behind this wall. The air-conditioning outdoor unit platform forms part of the common areas of the Phase. For details and location of the air-conditioning outdoor unit platform and the fittings, finishes and appliances, please refer to the sales brochure.

第1A座28樓A室單位的分體式空調機(室外機)裝置於此牆後之空調機室外機平台。該空調機室外機平台為期數的公用地方之一部分。有關空調機室外機平台及裝置、裝修物料及設備的資料及位置，請參閱售樓說明書。

DP-KTC2-SF-7

As the floor-to-ceiling height of this unmodified show flat is less than the corresponding projected height of the actual flat, the size of the air-conditioning indoor unit in this unmodified show flat does not represent the size of the air-conditioning indoor unit provided in the actual flat. The upper part of the air-conditioning indoor unit shown in this unmodified show flat is covered by the ceiling. As the floor-to-ceiling height of this unmodified show flat is 295mm less than the corresponding projected height of the actual flat, the upper part of the air-conditioning indoor unit shown in this unmodified show flat is covered by the ceiling by 227mm. The height of the air-conditioning indoor unit provided in the actual flat is 302mm. Please refer to the sectional plan and the photograph below showing the height of the air-conditioning indoor unit of the actual flat. Visible portion of the air-conditioning indoor unit of this unmodified show flat is shown in pink.

由於此無改動示範單位的樓底高度(地面量度至天花板計)比實際單位的相應預計高度少，此無改動示範單位空調機(室內機)並不反映實際單位提供的空調機(室內機)的大小。此無改動示範單位所展示的空調機(室內機)較上部分由天花所覆蓋。由於此無改動示範單位樓底高度(地面量度至天花板計)比實際單位的相應預計高度少295毫米，此無改動示範單位展示的空調機(室內機)較上部分被天花覆蓋227毫米。實際單位提供的空調機(室內機)高度為302毫米，實際單位提供的空調機(室內機)的高度請參閱以下截面圖及相片。此無改動示範單位之空調機(室內機)可視部分由粉紅色標示。



Due to physical constraint of this sales office, the associated cable conduit, power supply point, switch of air conditioning indoor unit have not been provided in this unmodified show flat. For information on fittings, finishes and appliances, please refer to the sales brochure.

由於本售樓處環境所限，該空調機(室內機)相關的電線導管、供電位、開關制在此無改動示範單位內並無提供。有關裝置、裝修物料及設備的資料，請參閱售樓說明書。

Notice(s) 告示 9

As the floor-to-ceiling height of this unmodified show flat is less than the corresponding projected height of the actual flat, the size of the air-conditioning indoor unit in this unmodified show flat does not represent the size of the air-conditioning indoor unit provided in the actual flat. The upper part of the air-conditioning indoor unit shown in this unmodified show flat is covered by the ceiling. As the floor-to-ceiling height of this unmodified show flat is 295mm less than the corresponding projected height of the actual flat, the upper part of the air-conditioning indoor unit shown in this unmodified show flat is covered by the ceiling by 220mm. The height of the air-conditioning indoor unit provided in the actual flat is 295mm. Please refer to the sectional plan and the photograph below showing the height of the air-conditioning indoor unit of the actual flat. Visible portion of the air-conditioning indoor unit of this unmodified show flat is shown in pink.

由於此無改動示範單位的樓底高度(地面量度至天花板計)比實際單位的相應預計高度少，此無改動示範單位空調機(室內機)並不反映實際單位提供的空調機(室內機)的大小。此無改動示範單位所展示的空調機(室內機)較上部分由天花所覆蓋。由於此無改動示範單位樓底高度(地面量度至天花板計)比實際單位的相應預計高度少295毫米，此無改動示範單位展示的空調機(室內機)較上部分被天花覆蓋220毫米。實際單位提供的空調機(室內機)高度為295毫米，實際單位提供的空調機(室內機)的高度請參閱以下截面圖及相片。此無改動示範單位之空調機(室內機)可視部分由粉紅色標示。

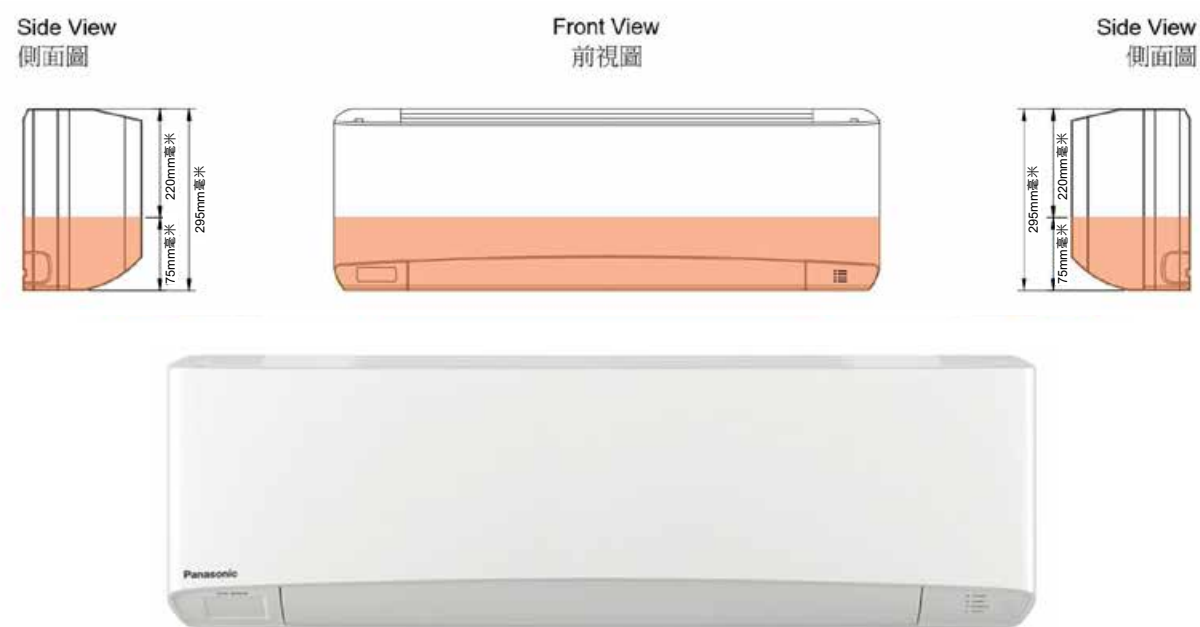

Due to physical constraint of this sales office, the associated cable conduit, power supply point, switch of air conditioning indoor unit have not been provided in this unmodified show flat. For information on fittings, finishes and appliances, please refer to the sales brochure.

由於本售樓處環境所限，該空調機(室內機)相關的電線導管、供電位、開關制在此無改動示範單位內並無提供。有關裝置、裝修物料及設備的資料，請參閱售樓說明書。

As the floor-to-ceiling height of this unmodified show flat is less than the corresponding projected height of the actual flat, the size of the air-conditioning indoor unit in this unmodified show flat does not represent the size of the air-conditioning indoor unit provided in the actual flat. The upper part of the air-conditioning indoor unit shown in this unmodified show flat is covered by the ceiling. As the floor-to-ceiling height of this unmodified show flat is 320mm less than the corresponding projected height of the actual flat, the upper part of the air-conditioning indoor unit shown in this unmodified show flat is covered by the ceiling by 245mm. The height of the air-conditioning indoor unit provided in the actual flat is 295mm. Please refer to the sectional plan and the photograph below showing the height of the air-conditioning indoor unit of the actual flat. Visible portion of the air-conditioning indoor unit of this unmodified show flat is shown in pink.

由於此無改動示範單位的樓底高度(地面量度至天花板計)比實際單位的相應預計高度少，此無改動示範單位空調機(室內機)並不反映實際單位提供的空調機(室內機)的大小。此無改動示範單位所展示的空調機(室內機)較上部分由天花所覆蓋。由於此無改動示範單位樓底高度(地面量度至天花板計)比實際單位的相應預計高度少320毫米，此無改動示範單位展示的空調機(室內機)較上部分被天花覆蓋245毫米。實際單位提供的空調機(室內機)高度為295毫米，實際單位提供的空調機(室內機)的高度請參閱以下截面圖及相片。此無改動示範單位之空調機(室內機)可視部分由粉紅色標示。

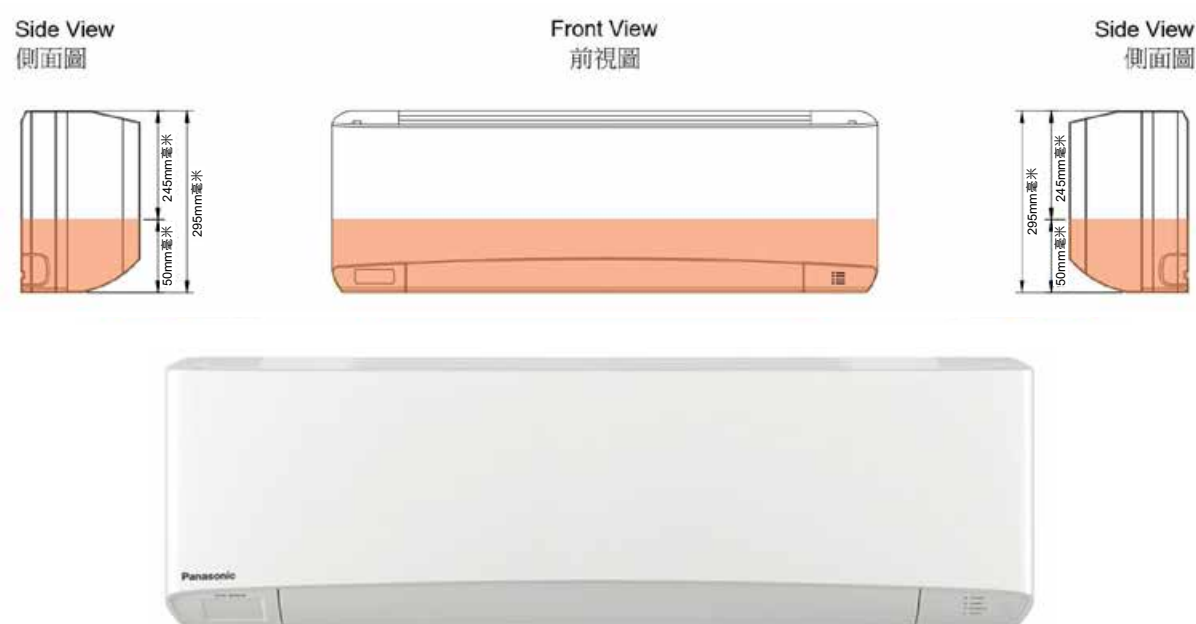

Due to physical constraint of this sales office, the associated cable conduit, power supply point, switch of air conditioning indoor unit have not been provided in this unmodified show flat. For information on fittings, finishes and appliances, please refer to the sales brochure.

由於本售樓處環境所限，該空調機(室內機)相關的電線導管、供電位、開關制在此無改動示範單位內並無提供。有關裝置、裝修物料及設備的資料，請參閱售樓說明書。

As the floor-to-ceiling height of this unmodified show flat is less than the corresponding projected height of the actual flat, the size of the air-conditioning indoor unit in this unmodified show flat does not represent the size of the air-conditioning indoor unit provided in the actual flat. The upper part of the air-conditioning indoor unit shown in this unmodified show flat is covered by the ceiling. As the floor-to-ceiling height of this unmodified show flat is 320mm less than the corresponding projected height of the actual flat, the upper part of the air-conditioning indoor unit shown in this unmodified show flat is covered by the ceiling by 245mm. The height of the air-conditioning indoor unit provided in the actual flat is 295mm. Please refer to the sectional plan and the photograph below showing the height of the air-conditioning indoor unit of the actual flat. Visible portion of the air-conditioning indoor unit of this unmodified show flat is shown in pink.

由於此無改動示範單位的樓底高度(地面量度至天花板計)比實際單位的相應預計高度少，此無改動示範單位空調機(室內機)並不反映實際單位提供的空調機(室內機)的大小。此無改動示範單位所展示的空調機(室內機)較上部分由天花所覆蓋。由於此無改動示範單位樓底高度(地面量度至天花板計)比實際單位的相應預計高度少320毫米，此無改動示範單位展示的空調機(室內機)較上部分被天花覆蓋245毫米。實際單位提供的空調機(室內機)高度為295毫米，實際單位提供的空調機(室內機)的高度請參閱以下截面圖及相片。此無改動示範單位之空調機(室內機)可視部分由粉紅色標示。

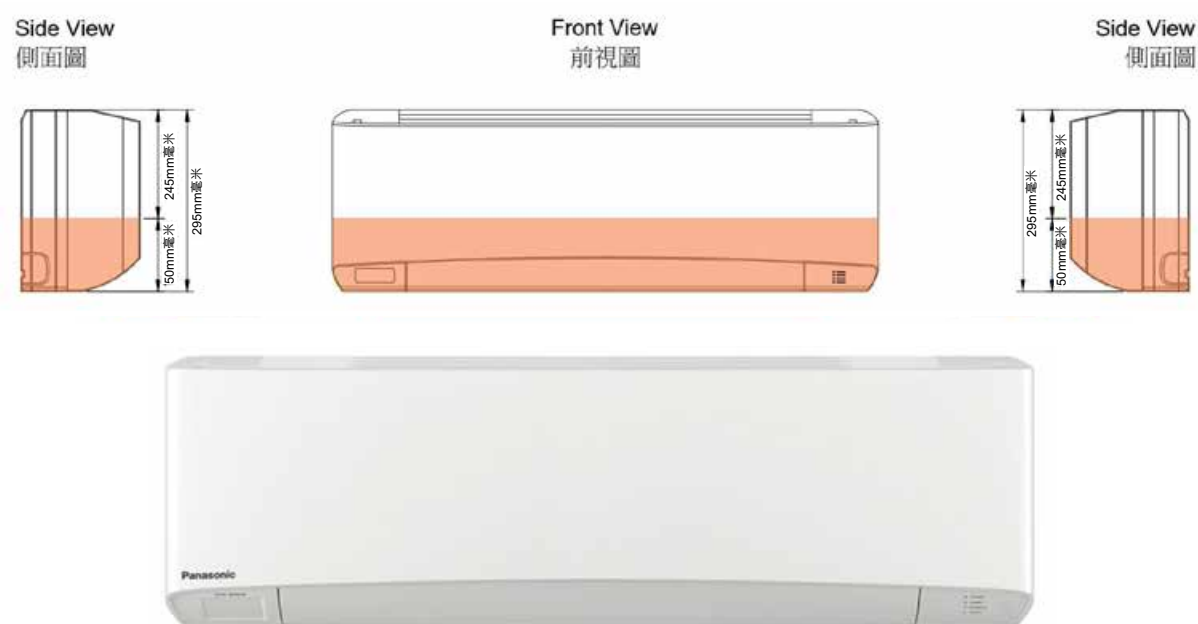

Due to physical constraint of this sales office, the associated cable conduit, power supply point, switch of air conditioning indoor unit have not been provided in this unmodified show flat. For information on fittings, finishes and appliances, please refer to the sales brochure.

由於本售樓處環境所限，該空調機(室內機)相關的電線導管、供電位、開關制在此無改動示範單位內並無提供。有關裝置、裝修物料及設備的資料，請參閱售樓說明書。



As the floor-to-ceiling height of this unmodified show flat is less than the corresponding projected height of the actual flat, the size of the air-conditioning indoor unit in this unmodified show flat does not represent the size of the air-conditioning indoor unit provided in the actual flat. The upper part of the air-conditioning indoor unit shown in this unmodified show flat is covered by the ceiling. As the floor-to-ceiling height of this unmodified show flat is 320mm less than the corresponding projected height of the actual flat, the upper part of the air-conditioning indoor unit shown in this unmodified show flat is covered by the ceiling by 245mm. The height of the air-conditioning indoor unit provided in the actual flat is 295mm. Please refer to the sectional plan and the photograph below showing the height of the air-conditioning indoor unit of the actual flat. Visible portion of the air-conditioning indoor unit of this unmodified show flat is shown in pink.

由於此無改動示範單位的樓底高度(地面量度至天花板計)比實際單位的相應預計高度少，此無改動示範單位空調機(室內機)並不反映實際單位提供的空調機(室內機)的大小。此無改動示範單位所展示的空調機(室內機)較上部分由天花所覆蓋。由於此無改動示範單位樓底高度(地面量度至天花板計)比實際單位的相應預計高度少320毫米，此無改動示範單位展示的空調機(室內機)較上部分被天花覆蓋245毫米。實際單位提供的空調機(室內機)高度為295毫米，實際單位提供的空調機(室內機)的高度請參閱以下截面圖及相片。此無改動示範單位之空調機(室內機)可視部分由粉紅色標示。

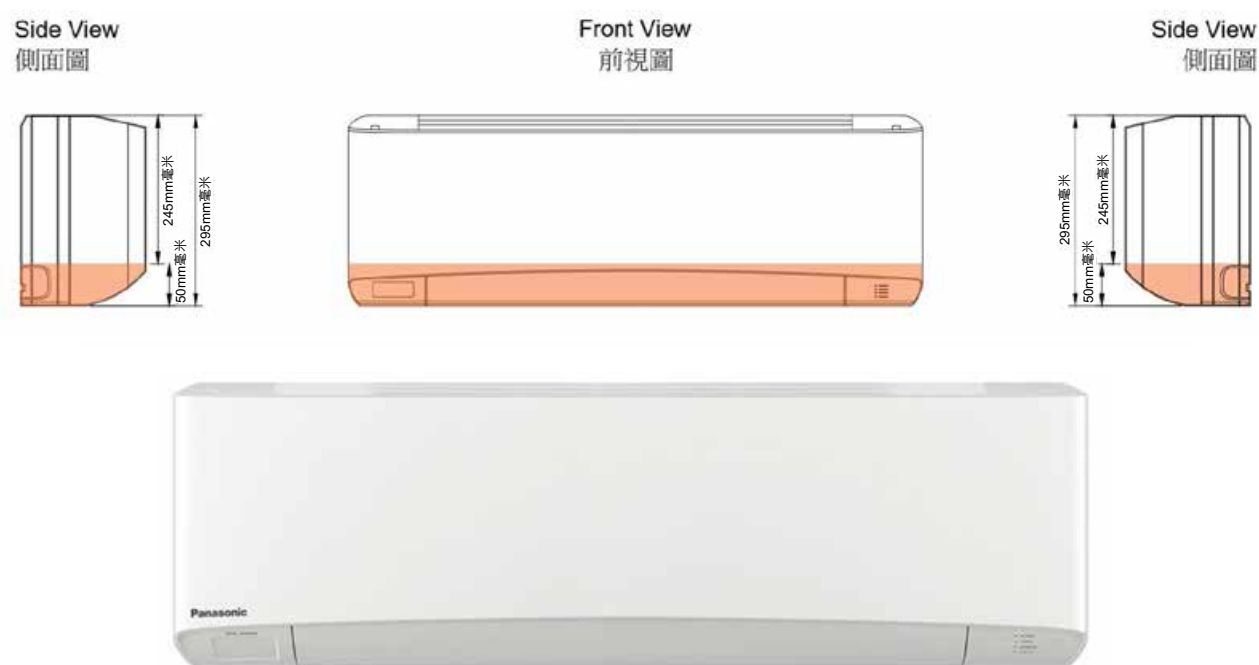

Due to physical constraint of this sales office, the associated cable conduit, power supply point, switch of air conditioning indoor unit have not been provided in this unmodified show flat. For information on fittings, finishes and appliances, please refer to the sales brochure.

由於本售樓處環境所限，該空調機(室內機)相關的電線導管、供電位、開關制在此無改動示範單位內並無提供。有關裝置、裝修物料及設備的資料，請參閱售樓說明書。

Ventilation fan (and its associated pipes, switch(es), socket(s), etc.) and sprinkler head will be hidden by the bulkhead in the kitchen in the actual residential property. Due to physical constraint of this sales office, the ventilation fan (and its associated pipes, switch(es), socket(s), etc.) have not been provided in this unmodified show flat. For information on fittings, finishes and appliances, please refer to the sales brochure.

實際住宅物業廚房內之抽氣扇(及其附屬喉管、開關、插座等)將被假陣隱藏。由於本售樓處環境所限，該抽氣扇(及其附屬喉管、開關、插座等)在此無改動示範單位內並無提供。有關裝置、裝修物料及設備的資料，請參閱售樓說明書。

DP-KTC2-SF-13



Water heater, ventilation fan (and their associated pipes, switch(es), socket(s), etc.) will be hidden by the false ceiling in the bathroom in the actual residential property. Due to physical constraint of this sales office, the water heater, ventilation fan (and their associated pipes, switch(es), socket(s), etc.) have not been provided in this unmodified show flat. For information on fittings, finishes and appliances, please refer to the sales brochure.

實際住宅物業浴室內之熱水爐、抽氣扇(及其附屬喉管、開關、插座等)將被假天花隱藏。由於本售樓處環境所限，該熱水爐、抽氣扇(及其附屬喉管、開關、插座等)在此無改動示範單位內並無提供。有關裝置、裝修物料及設備的資料，請參閱售樓說明書。

DP-KTC2-SF-14

15. Bathroom 2 pcs

Ventilation fan (and their associated pipes, switch(es), socket(s), etc.) will be hidden by the false ceiling in the bathroom in the actual residential property. Due to physical constraint of this sales office, the ventilation fan (and their associated pipes, switch(es), socket(s), etc.) have not been provided in this unmodified show flat. For information on fittings, finishes and appliances, please refer to the sales brochure.

實際住宅物業浴室內之抽氣扇(及其附屬喉管、開關、插座等)將被假天花隱藏。由於本售樓處環境所限，該抽氣扇(及其附屬喉管、開關、插座等)在此無改動示範單位內並無提供。有關裝置、裝修物料及設備的資料，請參閱售樓說明書。

DP-KTC2-SF-15

200 x 100mm

Flat A, 28/F, Tower 1A – Bathroom Appliances  
第1A座28樓A單位－浴室設備

Appliances and fittings to be provided or installed in the Bathroom of Flat A on 28/F of Tower 1A:  
第1A座28樓A單位之浴室均配備或安裝以下設備及裝置：

Appliance	設備	Brand 品牌
Thermo Ventilator	浴室寶	Panasonic
Duct Type Ventilation Fan	風喉式抽氣扇	Gelec

Notes: The vendor reserves the right to substitute any fittings, finishes and appliances with other fittings, finishes and appliances in accordance with the provisions of the agreement for sale and purchase. Fittings, finishes and appliances provided in the actual residential property may have slight variations in colour, measurement, grain, texture, and/or workmanship.

附註：賣方保留權利按買賣合約條款以其他裝置、裝修物料及設備代替任何裝置、裝修物料及設備。提供於實際住宅物業的各項裝置、裝修物料及設備可能在顏色、尺寸、紋理、質地及/或手工上出現輕微差別。

Flat A, 28/F, Tower 1A – Master Bathroom Appliances  
第1A座28樓A單位－主人浴室設備

Appliances and fittings to be provided or installed in the Master Bathroom of Flat A on 28/F of Tower 1A:  
第1A座28樓A單位之主人浴室均配備或安裝以下設備及裝置：

Appliance	設備	Brand 品牌
Thermo Ventilator	浴室寶	Panasonic
Duct Type Ventilation Fan	風喉式抽氣扇	Gelec
Instantaneous Electric Water Heater	即熱式電熱水爐	Stiebel Eltron

Notes: The vendor reserves the right to substitute any fittings, finishes and appliances with other fittings, finishes and appliances in accordance with the provisions of the agreement for sale and purchase. Fittings, finishes and appliances provided in the actual residential property may have slight variations in colour, measurement, grain, texture, and/or workmanship.

附註：賣方保留權利按買賣合約條款以其他裝置、裝修物料及設備代替任何裝置、裝修物料及設備。提供於實際住宅物業的各項裝置、裝修物料及設備可能在顏色、尺寸、紋理、質地及/或手工上出現輕微差別。

All views projected in this unmodified show flat are not views from the actual residential property. The views do not constitute and shall not be construed as constituting any offer, undertaking, representation or warranty whether express or implied. The vendor advises prospective purchasers to refer to the sales brochure for any information on the Phase. The vendor also advises prospective purchasers to conduct an on-site visit for a better understanding of the development site, its surrounding environment and the public facilities nearby.

此無改動示範單位所示之景觀並非實際住宅物業的實景，並不構成亦不得詮釋作構成任何不論明示或隱含之要約、承諾、陳述或保證。賣方建議準買方參閱售樓說明書以了解期數的資料。賣方亦建議準買方到發展地盤作實地考察，以便對發展地盤、其周邊地區環境及附近的公共設施有較佳了解。

DP-KTC2-SF-18

The railing, floor and wall finishes of this balcony/utility platform are standard provisions of the residential property upon handover. The balcony/utility platform is a non-enclosed area and no alteration or addition shall be made or allowed. Please refer to the latest draft deed of mutual covenant and sub-deed of mutual covenant (if any) for details.

此露台/工作平台之圍欄、地台及牆身為住宅物業交樓標準。露台/工作平台為不可封閉之地方，任何人不得對其作出任何改動或加建。詳情請參閱公契及副公契(如有)的最新擬稿。

DP-KTC2-SF-19

This is open air space outside the building in the actual Phase.

在實際的期數中，此處是建築物外的露天空間。

DP-KTC2-SF-20



The air-conditioning outdoor unit platform of the actual residential unit forms part of the common areas of the Phase. Due to physical constraint of the venue, the height of such air-conditioning outdoor unit platform may be different from the air-conditioning outdoor unit platform of the actual residential property.

實際住宅物業的空調機室外機平台為該期數的公用地方之一部分。由於現場環境所限，該空調機室外機平台的高度可能與實際住宅物業的空調機室外機平台不同。

DP-KTC2-SF-21

The magnetic door holder(s) marked with red dots “●” in this unmodified show flat are not part of the standard provisions of the residential property. There are no such magnetic door holders in the residential properties of the Phase and it may not be possible to install such magnetic door holders in the actual residential properties. For information on fittings, finishes and appliances of the residential properties in the Phase, please refer to the sales brochure.

本無改動示範單位內以紅色圓點“●”標示之磁力門擋並非住宅物業之交樓標準。期數之住宅物業並沒有此等磁力門擋，亦未必可能裝設此等磁力門擋。有關期數之住宅物業的裝置、裝修物料及設備的資料，請參閱售樓說明書。

DP-KTC2-SF-22

Due to the finishes on the floor and ceiling of this unmodified show flat (including without limitation the false ceiling of the dining room and living room), it is possible that there will be a difference between the floor-to-ceiling height of the unmodified show flat obtained by taking measurements inside the unmodified show flat (it will not be able to take into account of the thickness of the aforesaid finishes when taking such measurements) and the projected height (less the aforesaid height difference) of the corresponding parts of the residential property.

因本無改動示範單位地板及天花板均有裝修物料(包括但不限於飯廳和客廳之假天花)，於無改動示範單位內量度出之樓底高度(地面量度至天花板計)(如此量度得出之樓底高度未能將上述裝修物料厚度納入計算之中)可能會與有關住宅物業相關部分減去上述高度差距後的相應預計高度不同。

“Projected height” in relation to a residential property, means the height of the residential property as calculated by deducting the thickness of the floor slab of the residential property as specified in relation to the residential property in the sales brochure of the Phase from the floor-to-floor height of the residential property as so specified.

「預計高度」就某住宅物業而言，指按照以下算式計算得出的該物業的高度：將期數的售樓說明書中就該物業指明的層與層之間的高度，減去如此指明的該物業的樓板的厚度。

DP-KTC2-SF-23

This is not a mockup of the actual condition of the area outside the entrance door of the actual unit. Provisions, materials and finishes outside the main entrance door frame of this unmodified show flat are those of this sales office, and do not represent the actual provisions of the unit upon handover to the purchaser, and is/are not a mock-up of the external wall of the Phase or any architectural feature or finishes thereon. Please note that the location and orientation of the actual door frame and door bell, etc. of the unit are different from those shown here. For information on standard fittings, finishes and appliances of the residential property, please refer to the sales brochure.

此處並非模擬實際單位大門外範圍之實際狀況。此無改動示範單位入口大門門框外之裝置、物料及裝修物料屬於本售樓處的裝置、物料及裝修物料，並不代表單位交付給買方時之實際裝置，並非期數外牆或期數外牆上之建築裝飾或裝修物料的模擬。單位實際門框及門鈴等之位置和方向與此處展示者不同，敬希注意。有關住宅物業之交樓標準裝置、裝修物料及設備的資料，請參閱售樓說明書。

DP-KTC2-SF-24

Flat A, 28/F, Tower 1A – Kitchen Appliances  
第1A座28樓A單位－廚房設備

Appliances and fittings to be provided or installed in the Open Kitchen of Flat A on 28/F of Tower 1A:  
第1A座28樓A單位之開放式廚房均配備或安裝以下設備及裝置:

Appliance	設備	Brand 品牌
Duct Type Ventilation Fan	風喉式抽氣扇	Gelec
Cooker Hood	抽油煙機	Miele
Gas Hob	煤氣煮食爐	Miele
Steam Combination Oven	蒸焗爐	Miele
Refrigerator	雪櫃	Siemens 西門子
Washer Dryer	洗衣乾衣機	Siemens 西門子
Microwave Oven	微波爐	Miele
Gas Water Heater	煤氣熱水爐	TGC

Notes: The vendor reserves the right to substitute any fittings, finishes and appliances with other fittings, finishes and appliances in accordance with the provisions of the agreement for sale and purchase. Fittings, finishes and appliances provided in the actual residential property may have slight variations in colour, measurement, grain, texture, and/or workmanship.

附註：賣方保留權利按買賣合約條款以其他裝置、裝修物料及設備代替任何裝置、裝修物料及設備。提供於實際住宅物業的各項裝置、裝修物料及設備可能在顏色、尺寸、紋理、質地及/或手工上出現輕微差別。

Unit A on 28 Floor of Tower 1A

The floor-to-floor height of the actual residential unit is 3.125 m. After deducting the thickness of the floor slab and finishes, the estimated height measured from the floor surface to the bottom of the ceiling is approximately 2.95 and 2.925 m\*. Due to physical constraints of the venue, the show flat cannot reflect the aforementioned heights, and visitors may experience the projected approximate location of the ceiling with finishes through mirror reflection (which is for reference only)^.

\*The corresponding projected height of this property is 3.0 and 2.975 m. ("Projected height" in relation to a residential property, means the height of the residential property as calculated by deducting the thickness of the floor slab of the residential property as specified in relation to the residential property in the sales brochure of the Phase from the floor-to-floor height of the residential property as so specified.)

^The mirror concerned is not part of the show flat or the standard provisions of the actual residential property, and will not appear or be provided in any residential property or other parts of the Development and/or the Phase.

第1A座28樓A單位

實際住宅物業的層與層之間的高度為3.125米。減去樓板及裝修物料之厚度後，預計由地板表面量度至天花底部之高度約為2.95及2.925米\*。由於現場環境所限，示範單位未能實際反映上述高度，參觀者可從鏡像^感受單位的一部分連同裝修物料後天花之預計大概位置（僅供參考）。

\*此物業的相應預計高度為3.0及2.975米。「預計高度」就某住宅物業而言，指按照以下算式計算得出的該物業的高度：將期數的售樓說明書中就該物業指明的層與層之間的高度，減去如此指明的該物業的樓板的厚度。

^有關鏡子並非示範單位或實際住宅物業之交樓標準之一部分，不會於發展項目及/或期數任何住宅物業或其他部分出現或提供。有關實際住宅物業的層與層之間的高度及相應預計高度，詳情請參閱售樓說明書。

DP-KTC2-SF-26